

HOW TO SEW

Costuming IV: A New Hope

THE TOOLS!

Sewing Needle: A needle that carries thread through Fabric. The length, thickness and shape determines its intended purpose.



Thread: Tightly twisted yarn used for sewing.



Shears: Scissors made specifically for fabric and thread. **NEVER USE THEM FOR ANYTHING ELSE.**



MORE STUFF

Pins: Used to hold fabric in place.

Sewing Machine: A machine to rapidly sew fabric. Capable of many different types of stitches.

Stitch: Stitches are the pattern that the thread is sewn through the fabric.

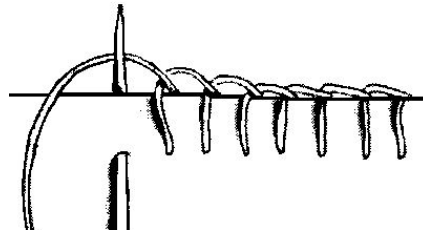

SEWING MACHINES!

Sewing machines have many parts, but all of them have these basic things:

Bobbin: A small spool of thread that goes INTO the machine.

Stitch Select: Lets you change the stitch you're doing.

Tension Select: Lets you select how loose or tight your thread is.

Stitch Length Select: Lets you change how long your stitches are.

How to Thread a Sewing Machine



Hand Stitching

Sewing machines are great for the larger projects, but often you'll be doing something small and delicate that a machine can't handle.

Hand stitching the ol' fashioned way is still a relevant and utilized skill in costuming. The following are three of the most basic and useful hand stitches.

Hand Stitching

1. Running Stitch:

Alternate back and forth through the fabric.

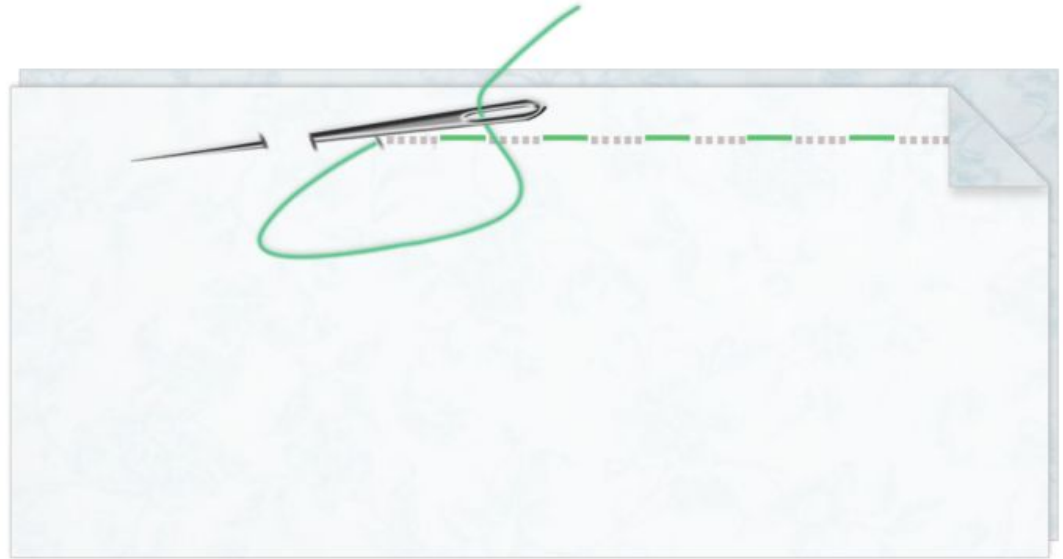

Hand Sewing

2. Back Stitch:

Like the running stitch, but this stitch goes back on itself.

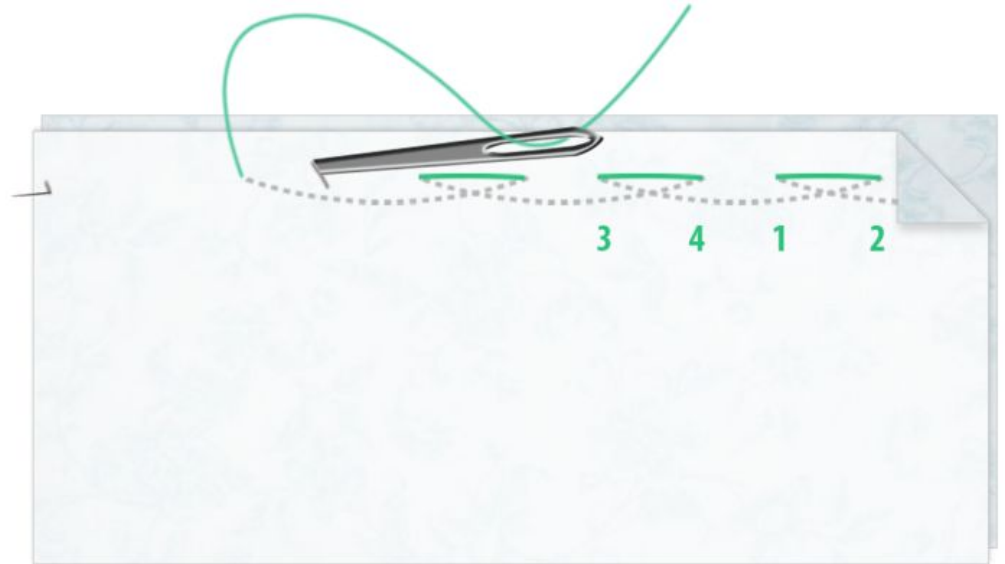

Hand Sewing

3. Overhand Stitch/ Whip Stitch:

A stitch that goes around the fabric as well as through.

Often used for closing up the hole that stuffing for stuffed animals is put through.

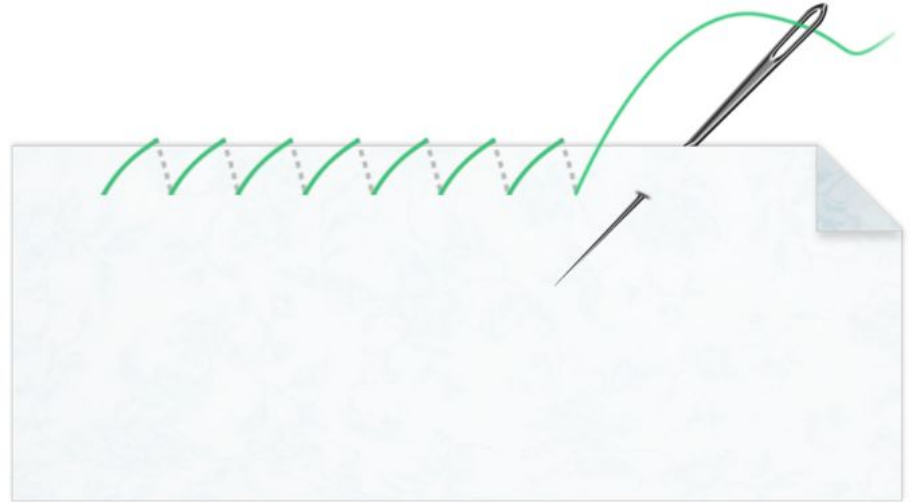

Hand Sewing

There are a bunch more stitches out there for all kinds of purposes. These are just the absolute basics.

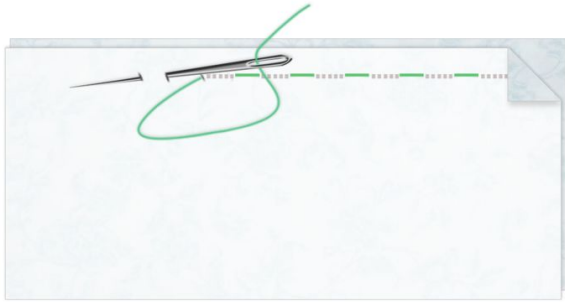

Running Stitch

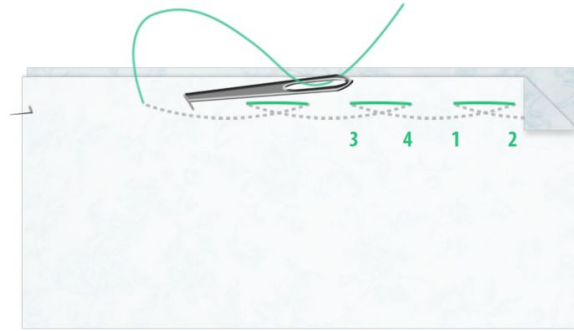

Back Stitch

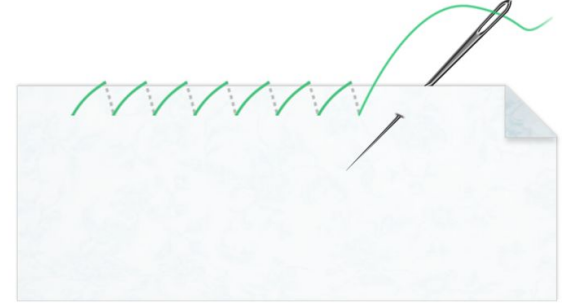

Whip Stitch